

EQUIPMENT REQUIRED:

Power Drill & Bits

Caulking Gun

Drywall Adhesive or Liquid Nails

Level

Chalk Line

Measuring Tape

Mounting Hardware

(may not be required)

Verify sizes and quantity of units delivered prior to installation. Contact Educational Equipment with any discrepancies at 330-673-4881.

It is important that walls be completely dry before installing a board, as any moisture may cause the panel inserts to warp and void warranty.

Complete hanging hardware is included with each unit. If wall construction prevents the use of hardware as furnished, it is the responsibility of the installer to furnish the required fasteners.

Aluminum frame markerboards & tackboards are furnished with one size L-Clip for use on both top and bottom of the frame.

1. Determine the desired height from the floor to the bottom of the board, strike a line, and attach the proper L-Clip to the wall by drilling 1/8" holes stud construction or 1/4" holes for the expansion plug installation for masonry construction (*screws should be fastened into existing wall studs*). **NOTE:** *Make certain that the bottom of the L-Clips are on the line when in the full down position. Place one L-Clip approximately 6" from each end and evenly space the others approximately 24" apart.*
2. Set board on bottom L-Clips and mark a reference line on wall along top of board as guide for positioning the top L-Clips. Install the same as above. **NOTE:** *The L-Clips along the top of the board should be positioned so that when the board is in place, the short leg of the L-Clips can be tapped down on top of the frame.*
3. The manufacturer recommends the use of a quality construction adhesive to ensure the integrity of the installation. Apply two (2) golf ball size spots evenly spaced in height approximately 4' on center on the back of the board.
4. Set board on L-Clips, pressing board back firmly against wall at location of adhesive spots.
5. With all L-Clips firmly attached to the wall, Drill a 1/8" hole through the short leg of the L-Clip through the aluminum frame & insert the # 6 x 1/2" tap screw through holes in the short leg of the L-Clips into the frame of the board. Care should be taken to ensure that the L-Clip does not protrude beyond the face of the trim.
6. Inspect the markerboard writing surface for protective clear plastic & remove if present. Clean the markerboard prior to use.

HEAD

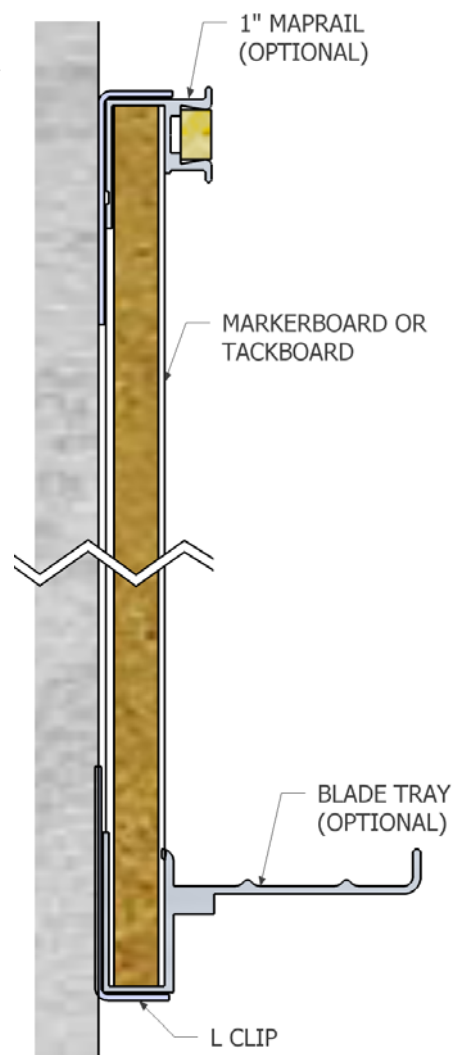

SILL